

X-X SEC

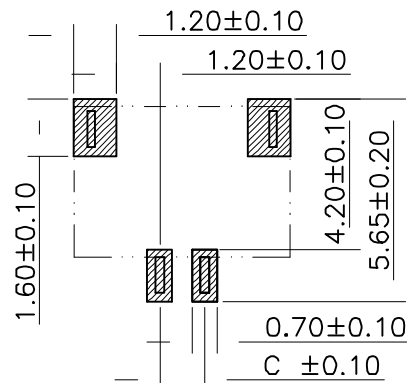
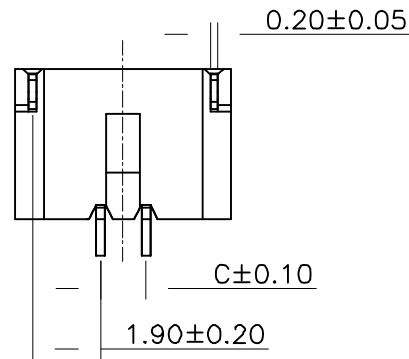

PCB LAYOUT

SPECIFICATIONS

Current Rating: 1A AC,DC
 Voltage Rating: 250V AC,DC
 Temperature Range: -25°C ~ +85°C
 Contact Resistance: 20mΩ Max.
 Insulation Resistance: 100MΩ Min.
 Withstanding Voltage: 500V AC/minute
 Contact: copper alloy/Gold-Plated
 Material: LCP,UL94V-0
 Color: Natural(Beige)

Ordering Information & Dimensions

PIN	A	B	C
2	6.00	3.90	1.25
3	7.25	5.15	2.50
4	8.50	6.40	3.75
5	9.75	7.65	5.00
6	11.00	8.90	6.25
7	12.25	10.15	7.50
8	13.50	11.40	8.75
9	14.75	12.65	10.00
10	16.00	13.90	11.25
11	17.25	15.15	12.50
12	18.50	16.40	13.75
13	19.75	17.65	15.00
14	21.00	18.90	16.25
15	22.25	20.15	17.50
20	28.50	26.40	23.75
25	34.75	32.65	30.00
30	41.00	38.90	36.25

UNITS
mm

QWYCONN 深圳市启威源电子有限公司
 SHENZHEN QIWEIYUAN ELECTRONIC CO.,LTD.

PART NO.(INTENDED USE)

A1255WR-S-XP

TITLE:
1.25mm PITCH 90°WAFER-SMT TYPE
ULTRA LOW PROFILE

APPD:

DWG NO.:

A1255WR-S-XP

CHKD:

DR:

HU 2016.09.25

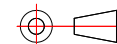

SCALE	SHEET	REV.
1/1	1/1	A

X. ± 0.3	X° ± 5°
.X ± 0.25	.X° ± 2°
.XX ± 0.20	.XX° ± 1°
.XXX ± 0.10	.XXX° ± 0.5°

FINISH

Q'TY