

P.C.B. LAYOUT
(TOP VIEW)

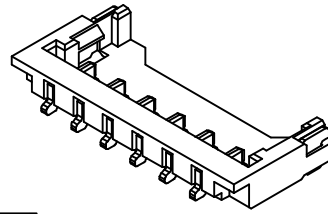

SPECIFICATIONS

Current Rating: 1.5A AC,DC
 Voltage Rating: 50V AC,DC
 Temperature Range: -25°C ~ +85°C
 Contact Resistance: 20mΩ Max.
 Insulation Resistance: 100MΩ Min.
 Withstanding Voltage: 500V AC/minute
 Pin Material: Brass/Gold-plated
 Solder Tabs: Brass/Gold-plated
 Material: Nylon 6T,UL94V-0
 Color: Black
 Qty/reel: 4500pcs

Ordering Information & Dimensions

PIN	A	B	C
2	1.20	4.20	2.65
3	2.40	5.40	3.85
4	3.60	6.60	5.05
5	4.80	7.80	6.25
6	6.00	9.00	7.45
7	7.20	10.20	8.65

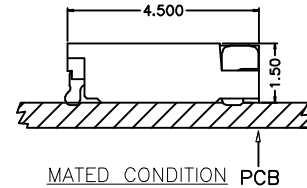
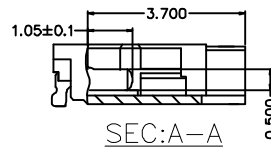
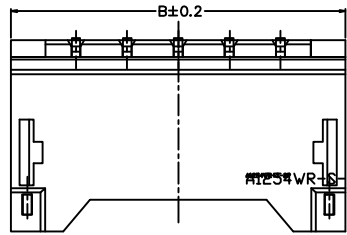
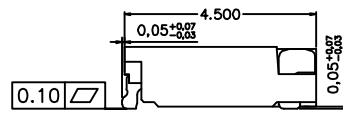
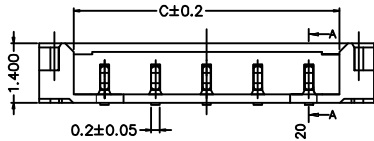

UNITS	mm	QWYCONN 深圳市启崴源电子有限公司 SHENZHEN QIWEIYUAN ELECTRONIC CO.,LTD.
MAT'L		
FINISH		PART NO.(INTENDED USE) A1201WV-S-XP
Q'TY		TITLE: 1.2mm PITCH 180°WAFER-SMT TYPE ULTRA LOW PROFILE
		APPD:
		CHKD:
		DR: HU 2016.09.25
		DWG NO.: A1201WV-S-XP
		SCALE
		SHEET
		REV.

X.± 0.3	X° ± 5°
.X ± 0.25	.X° ± 2°
.XX ± 0.20	.XX° ± 1°
.XXX ± 0.10	.XXX° ± 0.5°

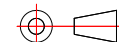

SCALE	SHEET	REV.
1/1	1/1	A